

**Top view**

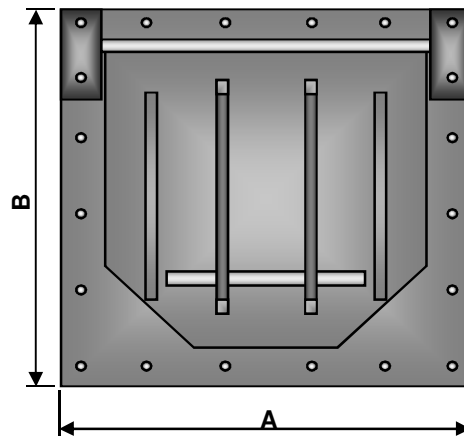

**Front view**

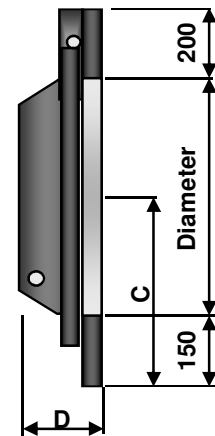

**Section**

Measurements in mm.

NW	Diam.	A	B	C	D	Weight in kg.
600	600	900	950	450	180	30
700	700	1000	1050	500	205	37
800	800	1100	1150	550	230	46
900	900	1200	1250	600	255	55
1000	1000	1300	1350	650	280	65
1100	1100	1400	1450	700	305	76
1200	1200	1500	1550	750	330	88

- Application** : End valve for surface water, sewers and other aggressive environments.  
: Suitable for wall mounting (concrete) with fixing bolts.
- Max. pressure** : 5 Metres head of water (for a short period).
- Materials** : Valve- and backplate HDPE.  
: Solid axle and ballast weight stainless steel 316.  
: Valve seal EPDM compound is attached on the rear of the flapvalve.
- Interface** : EPDM compound between valve and wall.
- Mounting** : Chemical anchor bolts or pre-cast anchors.
- Remarks** : Larger sizes and special shapes can be produced upon request.