

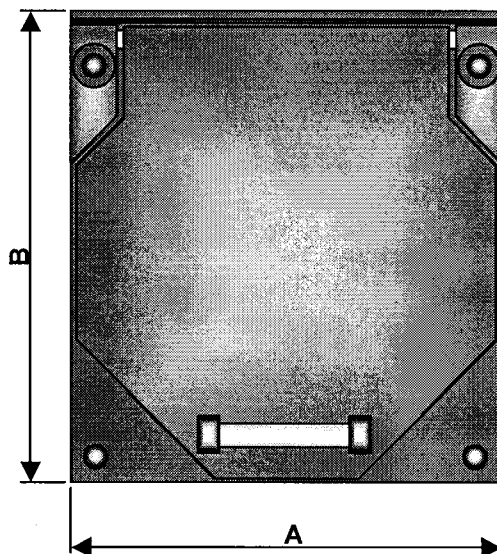

Top view

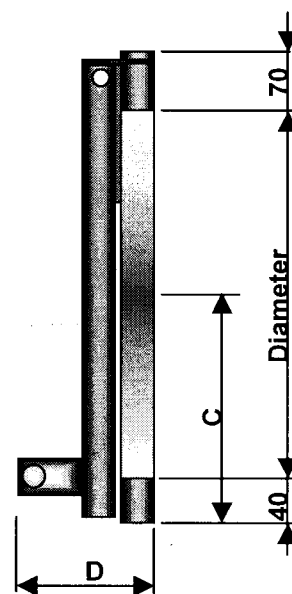

Front view



Section

Measurements in mm.

NW	Diam.	A	B	C	D	Weight in kg.
100	110	190	220	95	100	1
125	125	205	235	102,5	100	2
150	160	240	270	120	100	2
200	200	280	310	140	100	3
250	250	330	360	165	110	5
300	315	395	425	197,5	110	6
400	400	480	510	240	120	10
500	500	580	610	290	120	15

- Application** : End valve for surface water, sewers and other aggressive environments.
: Suitable for wall mounting (concrete) with fixing bolts.
- Max. pressure** : 5 Metres head of water.
- Materials** : Valve- and backplate HDPE.
: Solid axle and ballast weight stainless steel 316.
: Valve seal EPDM compound is attached on the rear of the flapvalve.
- Interface** : EPDM compound between valve and wall.
- Mounting** : Chemical anchor bolts or pre-cast anchors.
- Remarks** : Larger sizes and special shapes can be produced upon request.